

# Master Plan

**Northwest I.S.D. Schools**  
 Elementary School 14.48 ac.  
 Middle & High School 140.62 ac.

**Legend**

- Trail
- Floodplain Study Line
- Drillable Area Tract Number

Well Site = 10.71 ac. (≈3.87%)

Open Space = 77.16 ac. (≈27.87%)

50'x140' (107 Lots)

60'x120' (130 Lots)

75'x125' (72 Lots)

75'x150' (149 Lots)

100'x200' (46 Lots)

**Total 504 Lots**  
 276.86 Gross Acres

Developer:



**tnp**  
 teague nall & perkins

1100 Macon Street  
 Fort Worth, Texas 76102  
 817.336.3772 pk 817.336.3813 fx  
 TSP Registration No. F-230  
 www.tnpsc.com

**WEI**  
 Welch Engineering, Inc.

1308 Norwood Drive, Suite 200  
 Bedford, Texas 76022  
 Phone: 817-589-2900, Ext. 301

Planner:

**SAGE GROUP, INC.**  
 Master Planning  
 Urban Design  
 Architecture  
 Landscape Architecture

1130 N. Carroll Ave., Ste. 200  
 Southlake, Texas 76092  
 TEL. 817-424-2626

16 MAY 18

1" = 200'

0 200' 400' 800'

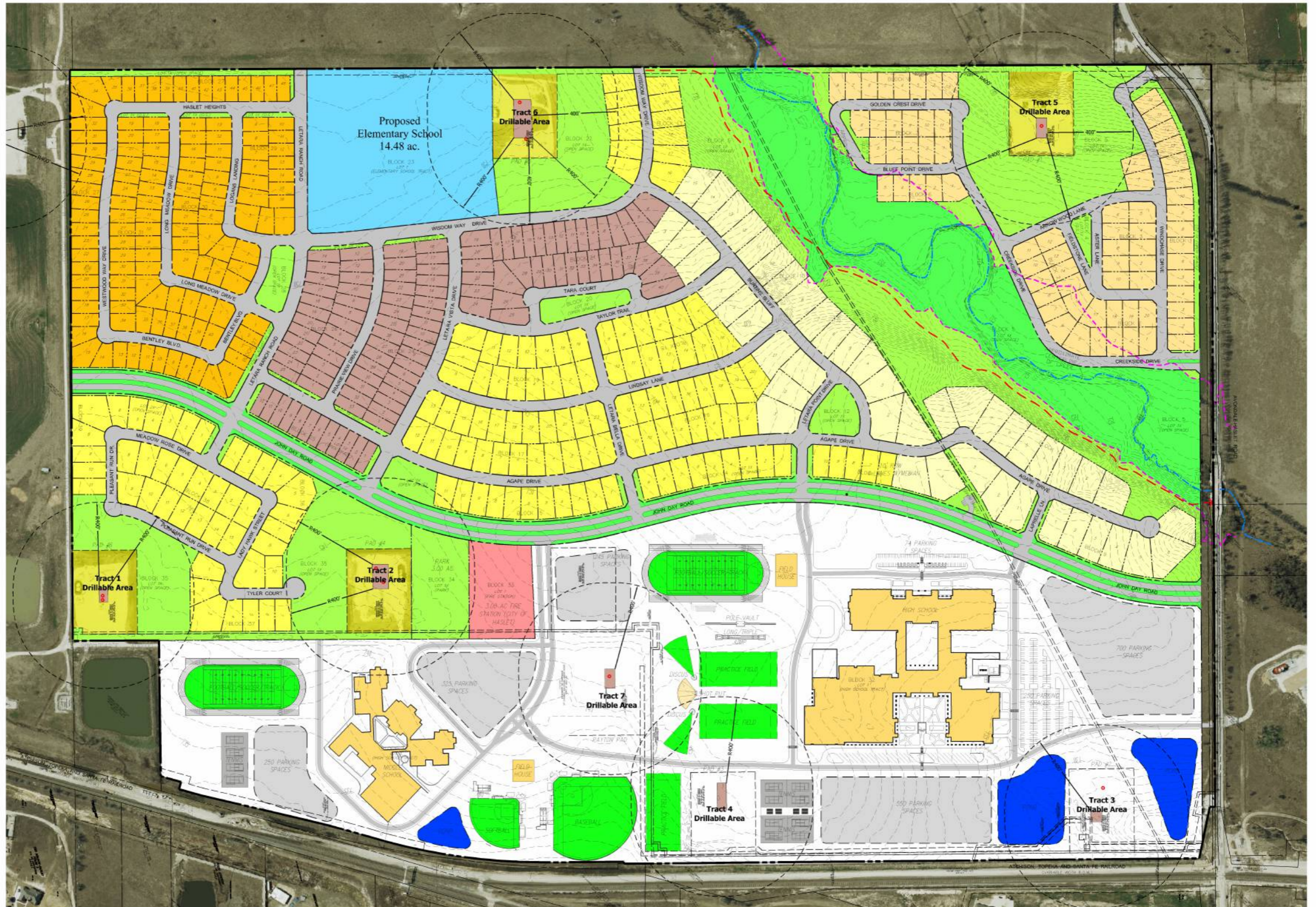

Haslet, Texas

LeTara